

XGT

40V Li-ion max

THE FUTURE IS POWERFUL



XGT**40V Li-ion max****Tool ◀▶ Battery ◀▶ Battery Charger
Digital communication**

XGT is a new system with its own tools, batteries, and chargers. A combination of innovative tool design and higher output batteries provide a genuine solution for high demand industrial users.

Optimum power supply system and Optimum charging system

The XGT range of tools and batteries come with a built-in program, providing digital communication between the battery and tool. Allowing not only for the battery to talk with tool but also the tool to talk to the battery. Battery technology and motor engineering that work together for optimum performance.

Optimum charging system

Auto maintenance system with two cooling fans for providing more optimum fast charging



40Vmax Li-ion Battery

BL4025
2.5Ah
191B36-3



BL4040
4.0Ah
191B26-6



Charging time

BL4025	28 min
BL4040	45 min

40Vmax Lithium-ion Battery Series

Built Tough

High durability specifications specially designed for 40Vmax Li-Ion batteries

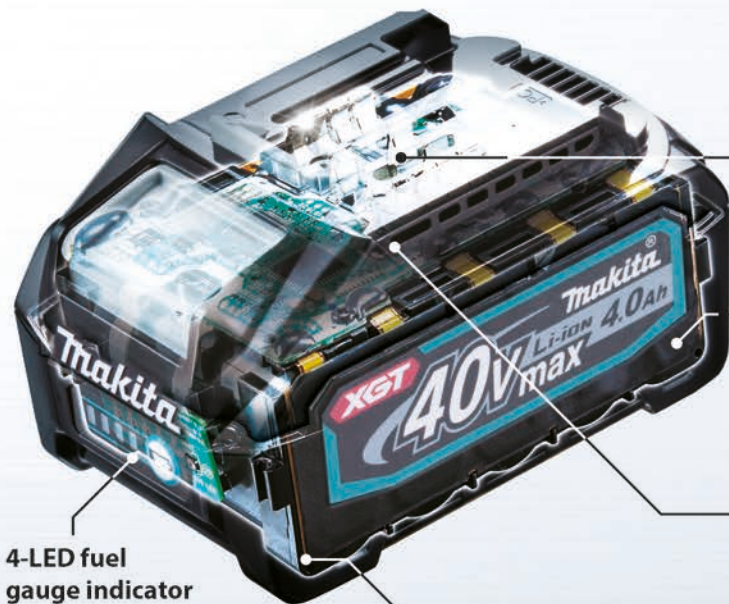

4-LED fuel gauge indicator

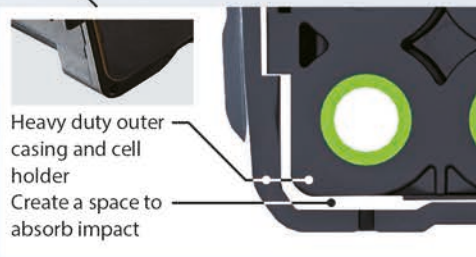

Heavy duty outer casing and cell holder
Create a space to absorb impact

Shock absorption structure

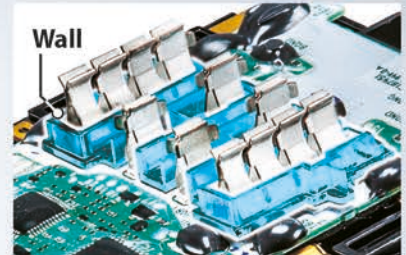

Terminal short-circuit prevention structure

The protection wall is provided between terminals against water and dust.

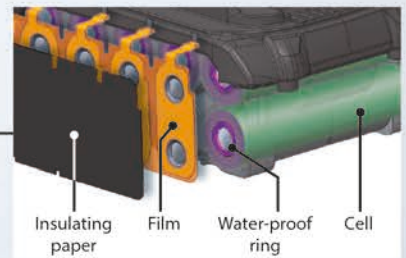

Waterproof Triple-layer Structure

prevents cell failure due to water and dust.

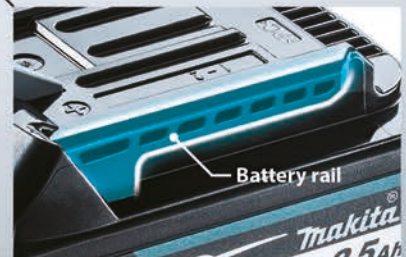

High Rigidity Battery Rails

Durable slide in battery rail that holds the battery and the tools firmly and securely to withstand high power products

40Vmax Fast Charger

The enlarged and raised LED light provides clearer indication of charging status.

DC40RA
191E08-6



Interchangeable Adapter

ADP10
191C10-7



Compatible with LXT Li-Ion batteries



Impact Driver
TD001G

TD001GZ - Body Only
TD001GD103 - 1 x 2.5Ah Li-ion + ADP10

Delivers 220N · m of Max Torque

10 Tightening modes

No load speed / Impacts per min (min ⁻¹)			
<p>Wood mode driving at low speed until fastening begins</p> <p>0 - 1,800 / 4,400</p>	<p>3 Bolt mode with rotation auto stop for tightening/ loosening bolts for more efficient work</p> <p>Mode1: 2,500 / - Mode2: 3,700 / 4,400 Mode3: 3,700 / 4,400</p>	<p>T1 Teks screw (thin metal) Driving self-drilling screws to a thin gauge metal like a metal stud</p> <p>0 - 2,400 / -</p>	<p>T2 Teks screw (thick metal) Driving self-drilling screws to a thick gauge metal</p> <p>0 - 3,700 / 2,600</p>

4 -Speed power selection



6 -Assist modes

No load speed / Impacts per min (min ⁻¹)			
<p>Max</p> <p>0 - 3,700 / 4,400</p>	<p>Hard</p> <p>0 - 3,200 / 3,600</p>	<p>Medium</p> <p>0 - 2,100 / 2,600</p>	<p>Soft</p> <p>0 - 1,100 / 1,100</p>

All complete models (with suffix GD101 / GD102 / GD103) comes with 1 x 2.5Ah battery, DC40RA Charger, ADP10 LXT Adaptor for XGT charger & Makpac Carry Case)
N.B. JR001GD102 Recipro Saw not supplied with Makpac Case.



BL MOTOR XPT

Rigid anvil holder with ball bearings reduces bit wobbling



about **15% UP**

Drives ϕ 6.5 x 120mm metal fastening screws

TD001G	115	2.5s
Predecessor Model 18V	100	
Slow		Fast

One-touch bit installation



Variable speed control by trigger

Twin LED job light



- **One-touch 4-speed selector** provides precise fastening control for a wide range of applications.
- **Quick-change memory mode** allows operator to rapidly change between two registered settings

Work amount on a full battery charge¹

Battery: BL4025

about 800 pcs Drove 65mm coarse thread screws	about 160 pcs Drove 120mm metal fastening screws
---------------------------------------------------------	------------------------------------------------------------

Capacity	Machine Screw: M4 - M8 (5/32" - 5/16") Standard Bolt: M5 - M16 (3/16" - 5/8") High Strength Bolt: M5 - M14 (3/16" - 9/16") Coarse thread (in length): 22 - 125 mm (7/8" - 4-7/8")
Hex Shank	6.35 mm (1/4")
No Load Speed (RPM)	Max / Hard / Med / Soft: 0 - 3,700 / 3,200 / 2,100 / 1,100
Impacts Per Minute (IPM)	Max / Hard / Med / Soft: 0 - 4,400 / 3,600 / 2,600 / 1,100
Max Fastening Torque	220 N·m (1,950 in.lbs.)
Fastening Torque	Hard / Med / Soft: 170 / 50 / 20 N·m (1,510 / 440 / 180 in.lbs.)
Sound Pressure Level	96 dB(A)
Sound Power Level	107 dB(A)
Dimensions (L x W x H)	w/ BL4025: 120x86x245 mm (4-3/4"x3-3/8"x9-5/8") w/ BL4040: 120x86x250 mm (4-3/4"x3-3/8"x9-7/8")
Net weight	1.7 - 2.0 kg (3.7 - 4.4 lbs.)

¹The test results depend to a great extent on the test material etc.



Hammer Driver Drill
HP001G
13 mm (1/2")

HP001GZ - Body Only
HP001GD102 - 1 x 2.5Ah Li-ion + ADP10

Delivers 140N · m of Max Torque

Solid performance

especially in heavy duty applications by efficient brushless motor and XGT battery



41 electronical clutch setting (21-stage setting in High mode)

A wider range of torque can be covered than mechanical clutch



Easy jog dial adjustment with digital display

AFT Active Feedback sensing Technology

turns the motor off if bit rotation is suddenly forced to stop.



Drove ø8 x 400mm long construction screws into 400mm thick SPF

HP001G	125
18V Predecessor Model	100

Slow Fast



Drilled holes through 38mm thick SPF with ø65mm (2 - 9/16") self-feeding bit

HP001G	135
18V Predecessor Model	100

Slow Fast



photo: HP001G

BL MOTOR AFT XPT



Mechanical 2-speed



Work amount on a full battery charge*¹
Work Battery: BL4025

about 40 pcs Drove ø8 x 400mm long construction screws into 400mm thick SPF	about 90 pcs Drilled holes through 38mm thick SPF with ø65mm (2 - 9/16") self-feeding bit	about 480 pcs Drilled holes through 38mm thick SPF with 7/8" Ship Auger bit
---------------------------------------------------------------------------------------	-----------------------------------------------------------------------------------------------------	---------------------------------------------------------------------------------------

Outstanding drilling speed **0 - 2600 min⁻¹**
at High speed mode

HP001G

Capacity	Steel: 20 mm (13/16") / Wood (Auger-Bit): 50 mm (2") Wood (Self-Feed Bit): 76 mm (3") / Wood (Hole Saw): 152 mm (6") Masonry: 20 mm (13/16")
Chuck Capacity	1.5 - 13 mm (1/16 - 1/2")
Impacts Per Minute (IPM)	High / Low: 0 - 39,000 / 0 - 9,750
No Load Speed (RPM)	High / Low: 0 - 2,600 / 0 - 650
Max Fastening Torque	Hard / Soft: 140 / 68 N·m (1,240 / 600 in.lbs.)
Max lock torque	125 N·m (1,100 in.lbs.)
Sound Pressure Level	85 dB(A)
Sound Power Level	96 dB(A)
Dimensions (L x W x H)	w/ BL4025: 182x86x275 mm (7-1/8"x3-3/8"x10-7/8") w/ BL4040: 182x86x282 mm (7-1/8"x3-3/8"x11-1/8")
Net weight	2.7 - 3.0 kg (6.0 - 6.6 lbs.)

*1 The test results depend to a great extent on the test material etc.

Compact overall length for easy handling and control

181 mm DF001G

18V Predecessor Model



HP001G: 182mm



Angle Grinder

Slide switch: GA004G / GA005G
Paddle switch: GA012G / GA013G
115 mm (4-1/2") 125 mm (5")

GA004GZ - Body Only
GA004GD101 - 1 x 2.5Ah Li-ion + ADP10
GA005GZ - Body Only
GA005GD101 - 1 x 2.5Ah Li-ion + ADP10

GA012GZ - Body Only
GA012GD101 - 1 x 2.5Ah Li-ion + ADP10
GA013GZ - Body Only
GA013GD101 - 1 x 2.5Ah Li-ion + ADP10

Delivers same power as 1,000W corded grinders

High durability

- Large ball bearing supports the motor.
- New switch design to reduce contact weariness.

No load speed:
8,500min.⁻¹

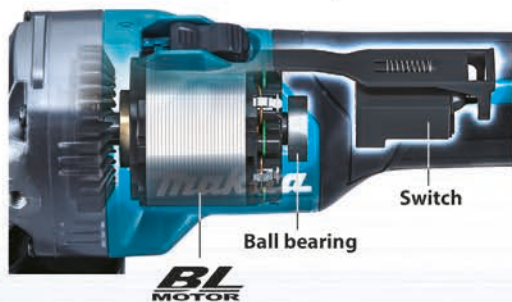

AFT Active Feedback sensing Technology

Shuts down the tool to protect the user, if the rotation speed suddenly slows down.

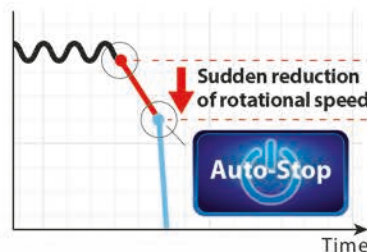

New toolless wheel cover

allows for fast and easy angle adjustment and installation / removal of wheel cover.

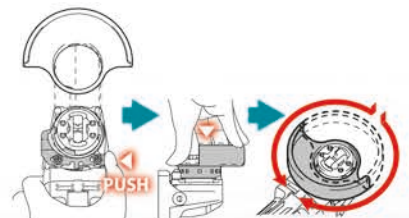

about
40% UP

Cut concrete at depths of 20mm

GA005G	140
18V Predecessor Model	100
Slow	Fast

Work amount on a full battery charge^{*1}

Battery: BL4040

about **7m**
Cutting depths: 20mm

Accessories

Dust collection wheel guard

191F81-2

191G06-2





BL MOTOR **AFT** **XPT** **(BRAKE)**

Slide Switch



GA005G / GA004G

Paddle Switch



GA013G / GA012G

Easy-to-hold slim grip



	GA004G	GA005G
Wheel Diameter	115 mm (4-1/2")	125 mm (5")
Hole Diameter	22.23 mm (7/8")	22.23 mm (7/8")
No Load Speed (RPM)	8,500	8,500
Sound Pressure Level	81 dB(A)	81 dB(A)
Sound Power Level	92 dB(A)	92 dB(A)
Dimensions (L x W x H)	w/ BL4025: 398x130x156 mm (15-5/8"x5-1/8"x6-1/8")	w/ BL4025: 398x140x156 mm (15-5/8"x5-1/2"x6-1/8")
	w/ BL4040: 410x130x168 mm (16-1/8"x5-1/8"x6-5/8")	w/ BL4040: 410x140x168 mm (16-1/8"x5-1/2"x6-5/8")
Net weight	2.9 - 3.5 kg (6.4 - 7.7 lbs.)	2.9 - 3.6 kg (6.4 - 7.9 lbs.)

	GA012G	GA013G
Wheel Diameter	115 mm (4-1/2")	125 mm (5")
Hole Diameter	22.23 mm (7/8")	22.23 mm (7/8")
No Load Speed (RPM)	8,500	8,500
Sound Pressure Level	81 dB(A)	81 dB(A)
Sound Power Level	92 dB(A)	92 dB(A)
Dimensions (L x W x H)	w/ BL4025: 398x130x156 mm (15-5/8"x5-1/8"x6-1/8")	w/ BL4025: 398x140x156 mm (15-5/8"x5-1/2"x6-1/8")
	w/ BL4040: 410x130x168 mm (16-1/8"x5-1/8"x6-5/8")	w/ BL4040: 410x140x168 mm (16-1/8"x5-1/2"x6-5/8")
Net weight	3.0 - 3.6 kg (6.6 - 7.9 lbs.)	3.0 - 3.6 kg (6.6 - 7.9 lbs.)

*1 The test results depend to a great extent on the test material etc.



Combination Hammer
HR003G / HR004G
28 mm (1-1/8")

HR003GZ - Body Only
HR003GD101 - 1 x 2.5Ah Li-ion + ADP10
HR004GZ - Body Only
HR004GD101 - 1 x 2.5Ah Li-ion + ADP10

HR004GD102 - 1 x 2.5Ah Li-ion + ADP10 + DX14 Dust Extraction attachment
HR004GD202 - 2x 2.5Ah Li-ion + DX14 Dust Extraction attachment

AVT Anti Vibration Technology

Vibration Level
7.0 m/s²



Redesigned Tool Balance for Increased Operability

The tool's center of gravity is located as close to the handle grip as possible, providing more control and less fatigue.

Lightweight

4.0kg

Model: HR004G
Battery: BL4025





Work amount on a full battery charge*1
 Battery: BL4025

about **120 pcs**
 Drilled holes a depth of 60mm (2-3/8") with ø12.5mm bit

BL MOTOR AVT XPT



Twin LED job light

Filter cleaning mechanism



Large dust box cover can be opened simply by pushing single push button for easy dust cleaning.



Dust Extraction System

DX12 / DX14 (191E54-9 / 191E60-4)



	Quick change drill chuck	AFT	AWS	Dust Extraction System
HR003G	—	—	—	DX12
HR004G	✓	—	—	DX14

	HR003G	HR004G
Impact Energy	EPTA-Procedure 05/2009: 2.8 J	EPTA-Procedure 05/2009: 2.9 J
Capacity	Concrete / Steel / Wood / Core Bit / Diamond Core Bit (Dry Type): 28 / 13 / 32 / 54 / 65 mm (1-1/8" / 1/2" / 1-1/4" / 2-1/8" / 2-9/16")	Concrete / Steel / Wood / Core Bit / Diamond Core Bit (Dry Type): 28 / 13 / 32 / 54 / 65 mm (1-1/8" / 1/2" / 1-1/4" / 2-1/8" / 2-9/16")
Blows Per Minute (BPM)	0 - 5,000	0 - 5,000
No Load Speed (RPM)	0 - 980	0 - 980
Chuck Capacity	1.5 - 13 mm (1/16 - 1/2")	1.5 - 13 mm (1/16 - 1/2")
Sound Pressure Level	95 dB(A)	93 dB(A)
Sound Power Level	106 dB(A)	104 dB(A)
Dimensions (L x W x H)	w/ BL4025: 358x102x232 mm (14-1/8"x4"x9-1/8") w/ BL4040: 373x102x238 mm (14-3/4"x4"x9-3/8")	w/ BL4025: 389x102x232 mm (15-1/4"x4"x9-1/8") w/ BL4040: 404x102x238 mm (15-7/8"x4"x9-3/8")
Net weight	3.9 - 4.6 kg (8.6 - 10.1 lbs.)	HR002G: 4.1 - 4.6 kg (9.0 - 10.1 lbs.) HR004G: 4.0 - 4.5 kg (8.8 - 9.9 lbs.)

*1 The test results depend to a great extent on the test material etc.



Circular Saw
HS004G
185 mm (7-1/4")

HS004GZ - Body Only
HS004GD103 - 1 x 2.5Ah Li-ion + ADP10

ADT Automatic torque Drive Technology

automatically changes the cutting speed according to load conditions for an optimum operation:

- On light duty: high-speed rotation mode
- On heavy duty: high torque mode

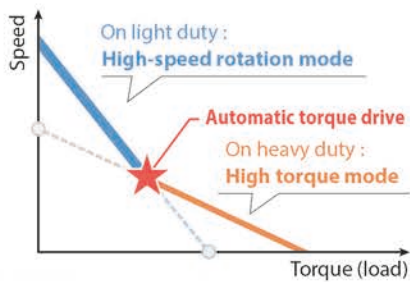

AWS Auto-start Wireless System



connects to a compatible dust extractor with Bluetooth. The Dust Extractor automatically runs while the switch is on.



Bluetooth

Switch on the tool



Dust Extractor is activated

Compatible with guide rail without adapter



Blower function



Twin LED Job light



Max. bevel capacity



Overload alert using driving mode lamp





photo: HS004G

BL MOTOR **ADT** **AWS** **(BRAKE)** **XPT**



Work amount on a full battery charge*1

Battery: BL4040

about **145 pcs**
Melapi
(thickness=60mm / width=300mm)

about **310 pcs**
SPF 2 x 10

Lightweight

4.4 kg

Battery: BL4040

Max cutting capacity at 90°

185mm 190mm
60 / 62.5 mm

Tool hanger
(optional accessory)



photo: HS004G

	HS004G
Blade Diameter	190 / 185 mm (7-1/2" / 7-1/4")
Max Cutting Capacity	90°: 62.5 / 60 mm (2-7/16" / 2-3/8") 45°: 44.5 / 43 mm (1-3/4" / 1-11/16") 48°: 42 / 41 mm (1-5/8" / 1-5/8")
No Load Speed (RPM)	6,000
Dimensions (L x W x H)	w/ BL4025: 322x210x290 mm (12-5/8"x8-1/4"x11-3/8") w/ BL4040: 337x210x290 mm (13-1/4"x8-1/4"x11-3/8")
Net weight	4.4 - 4.7 kg (9.7 - 10.4 lbs.)

*1 The test results depend to a great extent on the test material etc.



Recipro Saw
JR001G

JR004GZ - Body Only
JR004GD102 - 1 x 2.5Ah Li-ion + ADP10

Highly Durable Structure



Easy blade ejection lever



Smooth cutting with vertical crank system

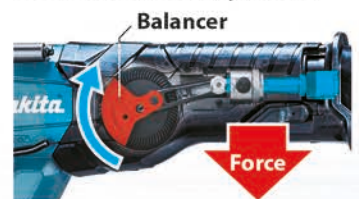

Tool-less shoe adjustment



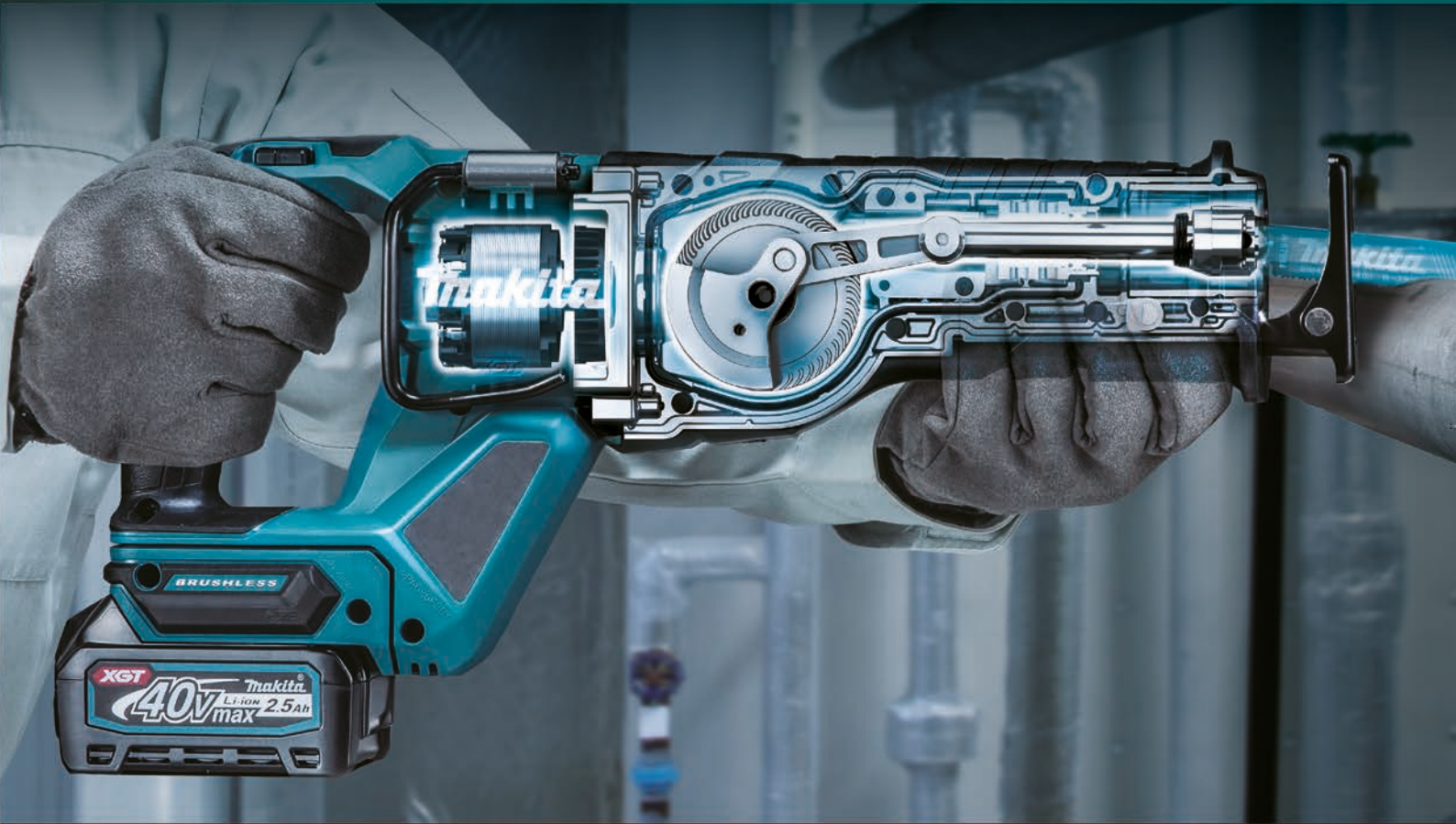

BL MOTOR XPT

High Cutting Speed

Metal Cutting speed about **10% UP**

ø25.4mm (1") Carbon steel pipe

JR001G	110
18Vx2 Predecessor Model	100

Slow Fast

Wood Cutting speed about **35% UP**

SPF 2 x 10

JR001G	135
18Vx2 Predecessor Model	100

Slow Fast



Twin LED job light



Easy-to-grip slim design

Work amount on a full battery charge^{*1}
Battery: BL4040

about **130 pcs**
ø25.4mm (1") Carbon steel pipe

about **155 pcs**
SPF 2 x 10

Lightweight

4.2 kg

Battery: BL4025

Tool hanger



Length of Stroke	32 mm (1-1/4")
Strokes Per Minute (SPM)	High / Low: 0 - 3,000 / 0 - 2,300
Capacity	Pipe: 130 mm (5-1/8") / Wood: 255 mm (10")
Sound Pressure Level	85 dB(A)
Sound Power Level	96 dB(A)
Dimensions (L x W x H)	w/ BL4025: 457x88x233 mm (18"x3-1/2"x9-1/8") w/ BL4040: 472x88x239 mm (18-5/8"x3-1/2"x9-3/8")
Net weight	4.2 - 4.5 kg (9.3 - 9.9 lbs.)

*1 The test results depend to a great extent on the test material etc.

Makita[®]



XGT 40v Max is the optimum system for applications where higher power and performance are required. XGT products are engineered to perform on the toughest applications and 40-volts delivered into tools that are specifically engineered for such applications is enough to tackle most tasks.

We could have gone for more power by simply developing higher voltage products, however there is a sacrifice of power versus runtime and charge times. Makita XGT 40v batteries offer longer runtimes via both 25Ah and 4Ah as the XGT batteries will deliver runtimes based on each batteries specific amp-hour capacity.

With some multi-voltage systems on the market, the runtimes are significantly reduced when batteries are connected to higher voltage machines – battery capacities can be reduced to 2Ah or lower, which means less runtime when you need the additional power. With Makita XGT batteries, the fuel tank (Ah / runtime) is not affected as the batteries are dedicated to working in line with the 40v Max range of machines.

All complete models (with suffix GD101 / GD102 / GD103) comes with 1 x 2,5Ah battery, DC40RA Charger, ADP10 LXT Adaptor for XGT charger & Makpac Carry Case)

N.B. JR001GD102 Recipro Saw not supplied with Makpac Case.

98N411 0620